



BY CHOICE HOTELS



ECONOLOGGE INTERIOR SIGNAGE PACKAGE

CONTACT:
AMY SCHEER
 316-267-4171 ext. 273
 316-267-6883 FAX
 amy.scheer@identitygroup.com

We Make Ordering Easy!

WAYFINDING

Send Graphics Systems, Inc. your hotel's floorplan and let us assist with your signage order. Our experienced wayfinding staff will determine your property's specific requirements and provide you with a detailed plan that includes a graphic of each sign, signtype, quantity, price and location, all in an easy to read format.

NO DESIGN FEES

Our talented design team will create any additional signage you require, including state and local code signage, free of charge.

NO MAP CHARGES

Our professional artists will draw your fire evacuation maps free of charge. Just send us your floorplans and we'll do the rest.

Guest Room Signage



4-1/2" x 4-1/2"
 RMN0505 ECO
 Guest Room Number

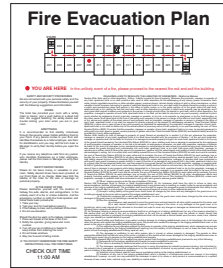

8-1/2" x 11"
 FEP0911B ECO
 Guest Room Evacuation
 with State Laws

Identification Signage



10" x 4"
 RID1004 ECO
 Room Identification

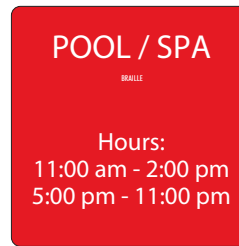

10" x 10"
 RID1010 ECO
 Room Identification with
 Hours Information



8" x 10"
 STR0810 ECO
 Stairwell Identification



6" x 8"
 RES0608 ECO
 Restroom Identification



6" x 8"
 STR0608B ECO
 In Case of Fire



6" x 8"
 STR0608 ECO
 Stairs Identification

Elevator/Corridor Signage



9-1/4" x 10-1/2"
 FEP1010 ECO
 Elevator/Corridor Evacuation Plan

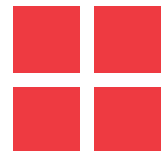

Directional Signage



12" x 6"
DIR1206 ECO
Directional, 1-2 Lines of Copy



12" x 9"
DIR1209 ECO
Directional, 3-4 Lines of Copy

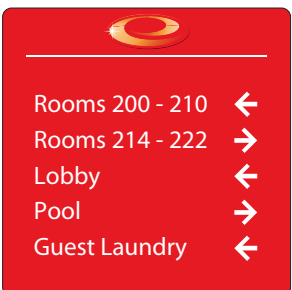

12" x 12"
DIR1212 ECO
Directional, 5-6 Lines of Copy

Front Desk Logo



30" x 22-3/4"
FDL3023
Front Desk Logo

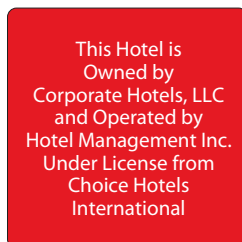

10" x 10"
INF1010B ECO
Owner/Operator



10" x 10"
INF1010B ECO
Owner/Operator Board

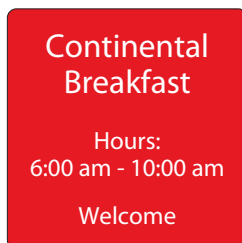

10" x 10"
INF1010 ECO
Continental Breakfast



10" x 1-1/2"
INS1002 ECO
Manager on Duty Nameplate

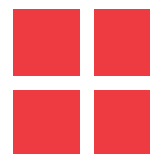

CHOICE HOTELS INTERNATIONAL

CORPORATE APPROVED LOBBY LOGOS NOW AVAILABLE FROM GRAPHICS SYSTEMS, INC.

Lobby logos shown are approved exclusively by Choice Hotels International for all corporate and franchise properties.

To place your order please fill out the form and FAX: 316-267-6883 or call: 316-267-4171.



63-1/2" w x 13-3/8" h
CQ 9.4HA Quality Inn
\$311.73



79-3/8" w x 14-1/2" h
CQ 9.7AA Comfort Suites (horizontal)
\$324.32



36-7/8" w x 33-3/4" h
CQ 9.7A Comfort Suites
\$349.83



30" w x 22-3/4" h
FDL3023 Econo Lodge
\$309.62



30" w x 22-3/4" h
FDL3024 Econo Lodge Inn & Suites
\$331.24



Comfort INN

BY CHOICE HOTELS

30-7/8" w x 39" h
CQ 10.4A Comfort Inn
\$298.86



Comfort INN & SUITES

BY CHOICE HOTELS

30-7/8" w x 38-5/8" h
CQ 10.5A Comfort Inn & Suites
\$339.85



18" x 18"
FDL1818 SLE
\$126.00



Clarion

BY CHOICE HOTELS

30-7/8" w x 28-1/2" h
CL 9.1A Clarion
\$313.65



Clarion Hotel

BY CHOICE HOTELS

30-7/8" w x 35" h
CL 9.2A Clarion Hotel
\$337.63



Clarion Resort

BY CHOICE HOTELS

30-7/8" w x 35-3/8" h
CL 9.3A Clarion Resort
\$334.99



BY CHOICE HOTELS

36-7/8" w x 19-1/8" h
ER 19.0A Rodeway Inn
\$293.50



18" x 18"
FDL1818 SLE-1
\$126.00



QUALITY INN

BY CHOICE HOTELS

31-7/8" w x 27-3/8" h
CQ 9.4A Quality Inn
\$324.54



QUALITY SUITES

BY CHOICE HOTELS

32-5/8" w x 26-3/4" h
CQ 9.5A Quality Inn & Suites
\$329.66



QUALITY INN & SUITES

BY CHOICE HOTELS

32-5/8" w x 26-3/4" h
CQ 9.8A Quality Inn & Suites
\$334.66



QUALITY HOTEL

BY CHOICE HOTELS

32-5/8" w x 26-3/4" h
CQ 9.9A Quality Hotel
\$329.66



BY CHOICE HOTELS

36-3/4" w x 25-1/4" h
MA 6.0A Mainstay Suites
\$318.68

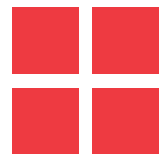

CHOICE HOTELS INTERNATIONAL LOBBY LOGO ORDER FORM

Please fill out the form below and FAX: 316-267-6883 or call: 316-267-4171.



Contact Name: _____ Purchase Order: _____ Date: _____
 Phone: (____) _____ FAX: (____) _____

Item No.	Property Logo	Face Color (choose one)		Optional Side Color Gold or Silver (20% upcharge)	Price	Total	Quantity	Total Price
		Polished Gold, Brushed Gold	Polished Silver, Brushed Silver					
FDL1818 SLE	Sleep Inn				+	126.00	x	=
FDL1818 SIS	Sleep Inn & Suites				+	126.00	x	=
MA 6.0A	Mainstay Suites				+	318.68	x	=
CL 9.1A	Clarion				+	313.65	x	=
CL 9.2A	Clarion Hotel				+	337.63	x	=
CL 9.3A	Clarion Resort				+	334.99	x	=
CQ 9.4	Quality Inn				+	324.54	x	=
CQ 9.4HA	Quality Inn (Horizontal)				+	311.73	x	=
CQ 9.5A	Quality Suites				+	329.66	x	=
CQ 9.8A	Quality Inn & Suites				+	334.66	x	=
CQ 9.9A	Quality Hotel				+	329.66	x	=
CQ 9.7A	Comfort Suites (Vertical/Stacked)				+	349.83	x	=
CQ 9.7AA	Comfort Suites (Horizontal)				+	324.32	x	=
CQ 10.5A	Comfort Inn & Suites				+	339.85	x	=
CQ 10.4A	Comfort Inn				+	298.86	x	=
FDL3023	Econo Lodge				+	309.62	x	=
FDL3024	Econo Lodge Inn & Suites				+	331.24	x	=
ER 10.0A	Rodeway Inn				+	293.50	x	=
SUBTOTAL								

Lobby Logos include mounting tape applied to the back, silicone adhesive, mounting template and registration marks. Custom sizes are also available. Call for pricing.

Note: Tax, Shipping and Handling are not included. We will ship via the method or carrier using our best judgement unless a specific carrier or routing instructions are clearly indicated at the time the order is placed. All shipments are F.O.B Plant of Origin. All prices shown are NET.

Following to be completed by Graphics Systems, Inc.

Sales Tax	
Shipping & Handling	
TOTAL	

PAYMENT METHOD:

VISA MC AMEX NUMBER _____
 EXP _____ CVV NO.* _____
 CARDHOLDER NAME _____
 SIGNATURE _____

* (3 digits on back of VISA or MC credit card or 4 digits on front of AMEX)

SHIP TO:

PROPERTY _____
 ATTENTION _____
 STREET ADDRESS _____
 CITY _____ STATE _____
 ZIP _____

313 Ida ▪ Wichita, KS 67211 ▪ (316) 267-4171 ▪ (316) 267-6883 fax ▪ www.graphicssystems.net

