

ARCHITECTURAL SIGN SYSTEMS



Fax Information & Form to:
Graphics Systems, Inc.
Fax No.: (316) 267-6883

COURTYARD THE BISTRO S-BAR HORIZONTAL MENU BOARD & CASHIER MENU

OPEN DATE: _____ RE-OPEN DATE: _____

PERSON ORDERING

Your Name: _____

Title: _____

Company: _____

Phone: _____

Fax: _____

E-mail Address: _____

MARSHA: _____

Courtyard Location: _____

SHIP TO ADDRESS

Name: _____

Company: _____

Street Address: _____

City, State Zip: _____

Phone: _____

BILL TO ADDRESS (if different than Ship To Address)

Name: _____

Company: _____

Street Address: _____

City, State Zip: _____

Phone: _____





Due to the nature of this product, we must receive information for your location prior to quoting. Please supply all information requested to make sure the menu boards fit the space available for installation.

Product leadtime is 4 weeks after receipt of final approval - for standard sizes, graphics and tier pricing. Custom leadtimes will be determined on a job to job basis.

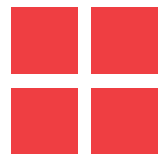

1 For The Bistro S-Bar, please tell us whether or not you have cabinets behind the menu board location. (Please Select One Box Below.)

- No Cabinets -Stationary Menu Board. This is the standard installation.
- Cabinets - Swivel Menu Board Required for Access to Cabinets.
Custom installation is required and will need to be documented accordingly through your design group.
- Menu Panels Only, Client has existing Menu Board's as shown on page 2.
(If this selection is chosen please sign and return Pages 1 & 3 only.)

2 Mark Graphics Type

- Standard Graphics - The Bistro S-Bar Standard Graphic Design
- Custom Graphics - If your hotel would like to design custom graphics, please note that The Bistro is a registered trademark of Marriott International and may not be altered in any fashion without written approval by Marriott International. Please submit custom artwork for menu board designs via e-mail to Maria.Rezende@Marriott.com. Graphics Systems will not produce custom menu boards until permission is granted from Marriott International. There will be an upcharge for custom design.

3 Verify Pricing and Menu

Since The Bistro is a branded F&B concept, Marriott International requires the same menu at each Courtyard. The menu will be reviewed as part of Marriott's Quality Assurance Program beginning June 2010. Hotels are not allowed to deviate from the standard menu without written permission from Lon.B.Southerland@Marriott.com.

For Marriott Managed hotels, please select from one of the four pricing tiers listed below. For Franchise Managed hotels, you are strongly encouraged to select from one of the four pricing models but not required. Individual hotel pricing can be adjusted as determined by your management company. There will be an upcharge for custom tier pricing.

Mark Pricing Tier

- Tier One Pricing
- Tier Two Pricing
- Tier Three Pricing
- Tier Four Pricing
- Tier Five Pricing

Mark Menu Type

- Core Menu (hotels with less than 140 rooms)
- Enhanced Menu (hotels with 140 rooms or more)

3a

Authorized Signature

Date

Print Name



4 Measured Drawing - Send Graphics Systems a measured drawing of your menu space. See standard example below.

Please note that Marriott requires all Courtyard locations to offer the same products. To add or delete products requires prior approval from Marriott International.

EXAMPLE FOR SWIVEL MENU BOARD (NOT TO SCALE)

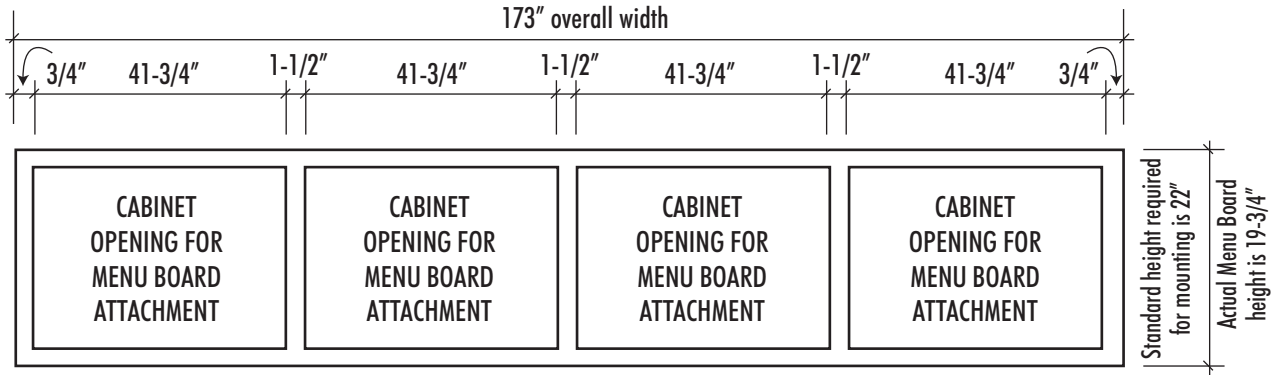

USING THE ABOVE EXAMPLE AS A GUIDE, FILL IN THE MEASUREMENTS FOR YOUR LOCATION

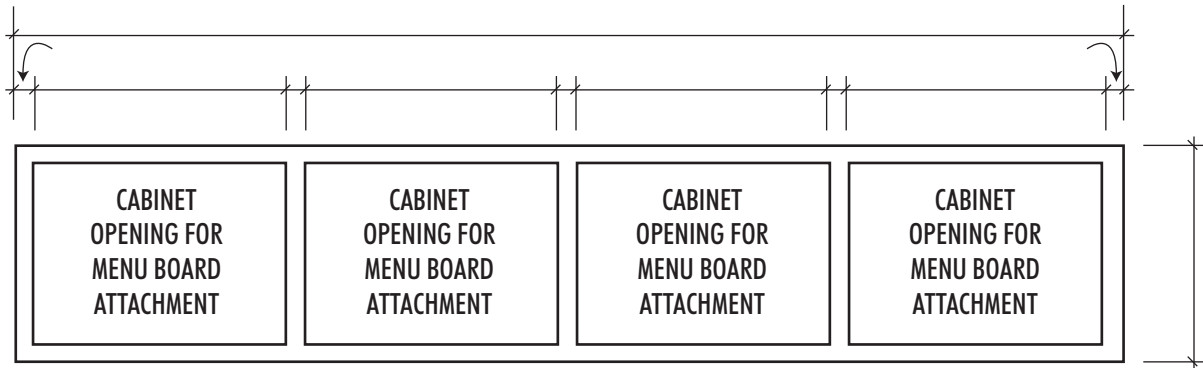

SIZES OTHER THAN THE STANDARD (AS SHOWN) WILL PAY AN UPCHARGE. The lead times for custom sizes will be longer than 4 weeks. Custom lead times will be determined on a job to job basis.



EXAMPLE FOR STATIONARY MENU BOARD (NOT TO SCALE)

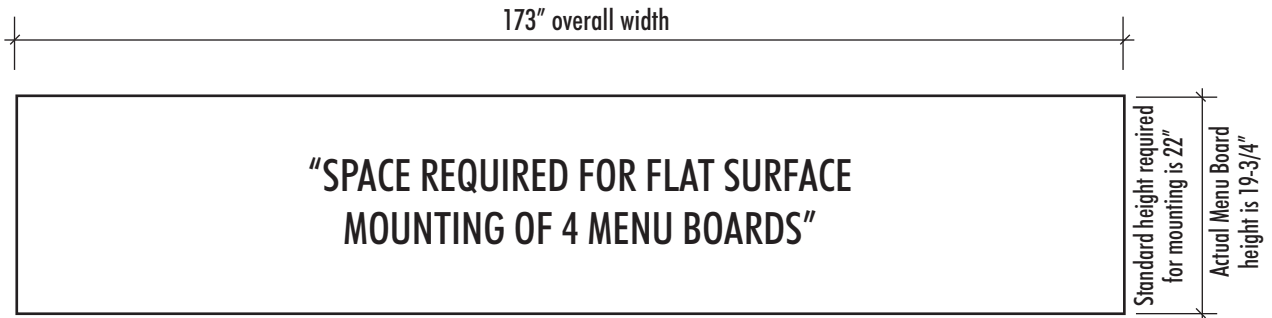

USING THE ABOVE EXAMPLE AS A GUIDE, FILL IN THE MEASUREMENTS FOR YOUR LOCATION

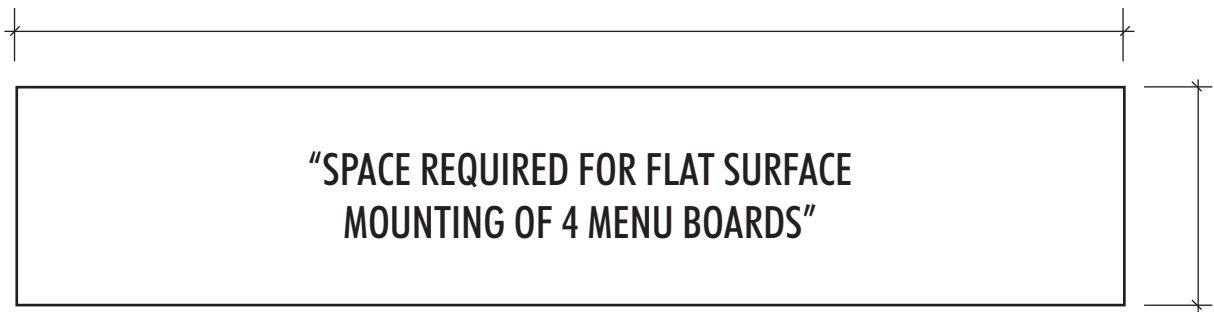

- 5** Installation Preparation - Please be aware that the property will supply the mounting board.
 Mounting Board Dimensions: overall width x 4" tall x 5/8" thick (shown highlighted in green)
 Mounting Board is to be laminated with Formica Deco Metal #4194 Stainless Aluminum
 (this matches The Bistro design specification).

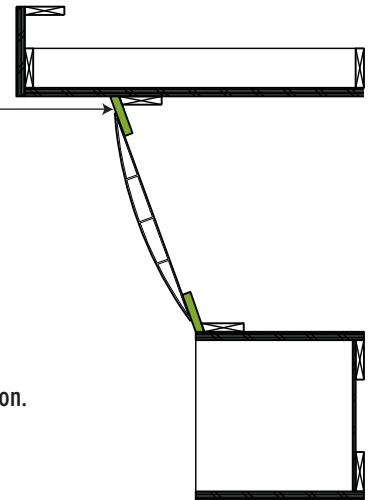

- 6** Fax Information and Form to Graphics Systems, Inc. at (316) 267-6883.
 Our design team will configure the menu board size & manufacturing specifications for your location.
 You will receive a quote and proof for approval prior to manufacture.

7 _____
 Authorized Signature

 Date

 Print Name

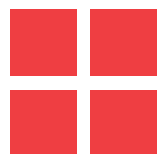



May be placed on counter-top in a flat or up-right position as shown.

Product leadtime is 2 weeks after receipt of final approval - for standard sizes, graphics, and tier pricing.

1

Verify Pricing and Menu

Hotels are not allowed to deviate from the standard menu without written permission from Lon.B.Southerland@Marriott.com.

For Marriott Managed hotels, please select from one of the four pricing tiers listed below. For Franchise Managed hotels, you are strongly encouraged to select from one of the four pricing models but not required. Individual hotel pricing can be adjusted as determined by your management company. There will be an upcharge for custom tier pricing.

Mark Pricing Tier

- Tier One Pricing
- Tier Two Pricing
- Tier Three Pricing
- Tier Four Pricing
- Tier Five Pricing

Mark Menu Type

- Core Menu (hotels with less than 140 rooms)
- Enhanced Menu (hotels with 140 rooms or more)

2

Verify Product to be ordered (Standard)

- Base and 2 Menu Panels - \$325.00
(Comes with am panel and pm panel)
 - There's an additional price for Seasonal offering decal.

3

Fax Information and Form to Graphics Systems, Inc. at (316) 267-6883.
You will receive a quote and proof for approval prior to manufacturing.

4

Authorized Signature _____

Date _____

