



**BAYMONT INN & SUITES  
INTERIOR SIGNAGE PACKAGE**

**CONTACT:**  
**DAINA BAILEY**  
 316-267-4171 ext. 234  
 316-267-6883 FAX  
 dbailey@gsi-graphics.com

**We Make Ordering Easy!**

**WAYFINDING**

Send Graphics Systems, Inc. your hotel's floorplan and let us assist with your signage order. Our experienced wayfinding staff will determine your property's specific requirements and provide you with a detailed plan that includes a graphic of each sign, signtype, quantity, price and location, all in an easy to read format.

**NO DESIGN FEES**

Our talented design team will create any additional signage you require, including state and local code signage, free of charge.

**NO MAP CHARGES**

Our professional artists will draw your fire evacuation maps free of charge. Just send us your floorplans and we'll do the rest.

*Graphics Systems, Inc. is approved by Baymont Inn & Suites to offer an interior signage package to licensees for use at their properties.*

*To order, call Daina Bailey at Graphics Systems, Inc.: (316) 267-4171 ext. 234.*

**Guest Room Signage**



6" x 4"  
 GRN 0604 BAY  
 Guest Room Number

**Identification Signage**

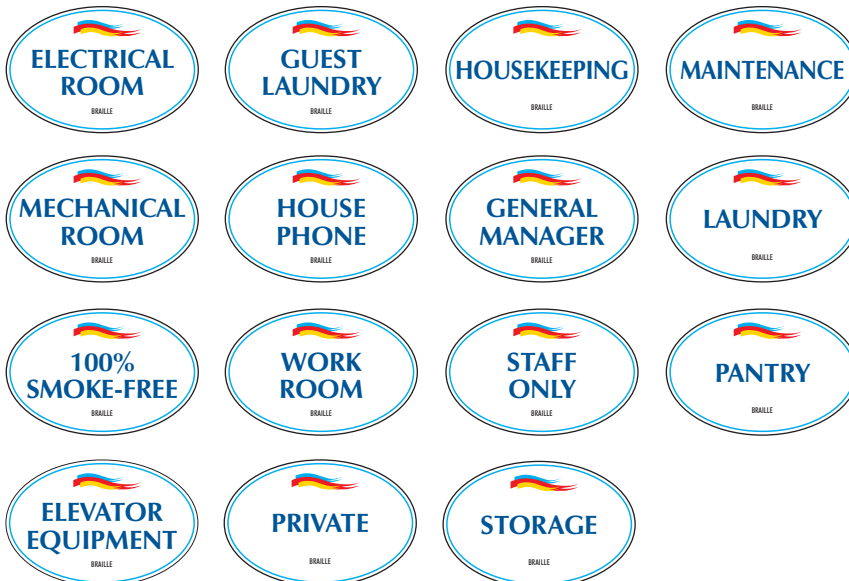

8" x 5-1/4"  
 ID 0805 BAY  
 Identification

**Logo Signage**

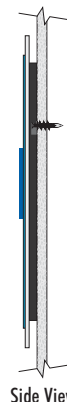

36" x 20"  
 LOGO 3620 BAY  
 Baymont Lobby  
 Logo, SMALL  
  
 50" x 27-1/2"  
 LOGO 5028 BAY  
 Baymont Lobby  
 Logo, LARGE

*Neither Wyndham Worldwide Corporation ("WWC") nor any of its affiliates, including its hotel franchise subsidiaries, provide any product or service in connection with this or other approved supplier programs. All products and services are provided by each approved supplier company.*



**Identification Signage continued**



10" x 6-1/2"  
ID 1007 DAY  
Large Room Identification



10" x 6-1/2"  
ID 1007B BAY  
Large Room Identification with Hour Information



9" x 10"  
RR 0910 DAY  
Restroom Identification



12" x 9-1/2"  
MTG 1210 BAY  
Meeting Room Identification  
with Available/In Use Slider



12" x 9-1/2"  
STR 1210 BAY  
Exit Stairs Identification

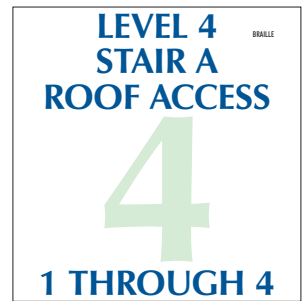

12" x 12-1/4"  
STR 1212 BAY  
Interior Stairwell Identification

**Directional Signage**



15" x 8-3/4"  
DIR 1509 BAY  
Directional, 1-3 Lines of Copy



15" x 12-1/4"  
DIR 1512 BAY  
Directional, 4-5 Lines of Copy

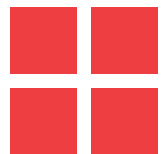

**Informational Signage**



12" x 9-1/2"  
MOD 1210 BAY  
Manager on Duty Board



8" x 1-1/2"  
INS 1210 BAY  
Name Insert for Manager on Duty Board



12" x 9-1/2"  
INF 1210 BAY  
Informationals



8" x 5-1/4"  
INF 0805 BAY  
Small Informational



10" x 6-1/2"  
INF 1007 BAY  
Large Informational



**Informational Signage continued**



**POOL**

- No Lifeguard on Duty. Swim at Your Own Risk. Do Not Swim Alone.
- No Diving. Maximum Pool Depth is 5'.
- Non-Swimmers & Children Under 14 Must Be Accompanied By a Responsible Adult.
- Glass Containers are Prohibited.
- Persons With Communicable Diseases Shall Not Use the Pool. Please Shower Before Entering the Pool.
- Persons Under the Influence of Alcohol or Drugs Shall Not Use Pool.
- Running and Horseplay are Prohibited.



**WHIRLPOOL**

- CAUTION: Long Exposure May Result in Nausea, Dizziness or Fainting.
- Limit Sessions to 15 Minutes.
- Children Under 14 Must Be Accompanied by an Adult.
- Hot Water Immersion While Under the Influence of Alcohol, Narcotics, Drugs or Medicines May Lead to Serious Consequences and is Not Recommended.
- Elderly Persons, Pregnant Women and Those with Health Conditions Requiring Medical Care Should Consult a Physician Before Using the Whirlpool.



**FITNESS CENTER**  
CENTER IS FOR USE OF REGISTERED GUESTS ONLY.

- Use Equipment as Directed in the Posted Instructions
- Do Not Exercise Alone.
- Children Under 14 Must Be Accompanied By an Adult.
- Center is Not Supervised. User Assumes All Risks and Baymont or Any Affiliated Entity is Not Responsible for Injuries Relating to the Use of Equipment.
- Eating, Drinking or Horseplay is Not Permitted.
- Consult Your Physician Prior to Exercising. Do Not Over-Exercise. At the First Sign of Discomfort, Discontinue Use Immediately.



**NO DIVING**  
**NO LIFEGUARD ON DUTY**



**EMERGENCY - CALL 911**

**You Are At**  
**Baymont Inn & Suites**  
**313 Ida**  
**Wichita, KS 67209**



**Guests' Laundry**

FOR GUEST USE ONLY.  
NOT RESPONSIBLE FOR LOST OR DAMAGED ARTICLES.  
USE AT YOUR OWN RISK.  
BAYMONT INN DOES NOT PROVIDE AN ATTENDANT FOR THE OPERATION OF LAUNDRY EQUIPMENT.  
READ ALL OPERATING INSTRUCTIONS.  
DO NOT LEAVE PERSONAL PROPERTY UNATTENDED.  
GLASS CONTAINERS ARE NOT PERMITTED.

15" x 12-1/4"  
INF 1512 BAY  
Large Informationals

